

Vers-a-shelf 'WS' wood wall shelf © Copyright ESE

21 September 2006. This drawing superceeds all others, any discrepancies please report ASAP.

Please make sure wall fixings are suitable for the type of wall you are fixing to (not supplied)

Secure the wall brackets to the wall @ 1040mm (WS12), 1340mm (WS15), 1640mm (WS18) or 1940mm (WS21) apart (inside box section to inside box section).
Before tightening, Slide chrome rail through centre bracket (not included with WS12) and locate in wall brackets and add captive coat hangers if being used.
Then fix the wood slats through the holes using the screws provided and fix the centre rail support to wood (if provided).

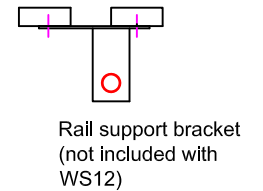
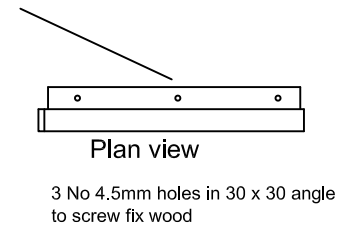
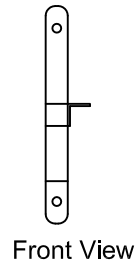
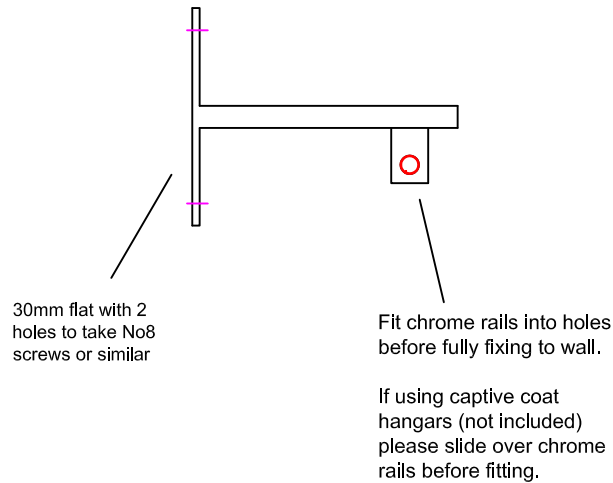

1 pair of frames per WS shelf set from 30X30 with 50x25 box return for chrome rail

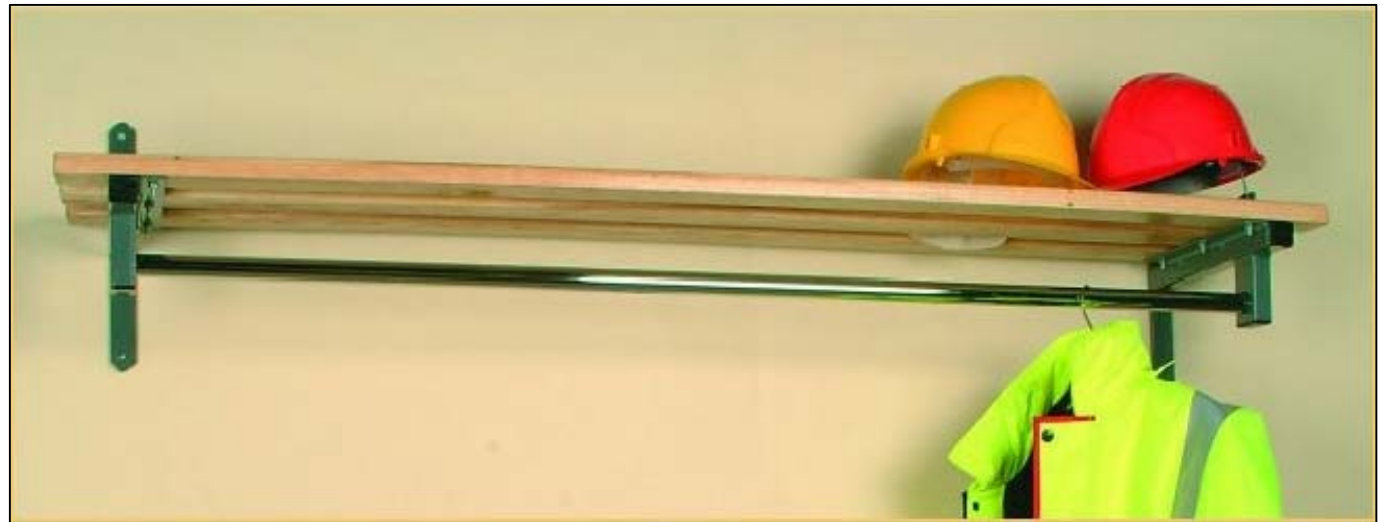

Unwrap all components carefully and check quantities (please report discrepancies by return).
Please make sure all bolts and screws are well tightened before use.